

# COLUMBO®

## 0.8 MG

**Microgranule multicrop insecticide**  
**Effective against wireworms, cutworms**  
**Close protection for seedlings and plants**

UFI: HUA5-SCM4-960P-NAJ4

**PROFESSIONAL USE ONLY - USE PESTICIDES SAFELY**

Composition: Cypermethrin: 0,8 % w/w (8 g/kg)  
Formulation: Microgranules (MG)  
For use as an agricultural insecticide



**WARNING**

**SAFETY INFORMATION**

**Very Toxic to aquatic life with long lasting effects.**

If medical advice is needed, have product container or label at hand.  
Keep out of reach of children.  
Do not eat, drink or smoke when using this product.  
Keep away from food, drink and animal feedstuffs.  
Wear protective gloves/protective clothing/eye protection/face protection.  
Wash hands thoroughly after handling.  
Collect spillage.

Dispose of contents/container to a licensed hazardous waste disposal contractor or collection site except for triple rinsed empty containers which can be disposed of as non-hazardous waste.

Do not contaminate water with the product or its container (Do not clean application equipment near surface water/Avoid contamination via drains from farmyards and roads).

**TO AVOID RISKS TO HUMAN HEALTH AND THE ENVIRONMENT, COMPLY WITH THE INSTRUCTIONS FOR USE.**  
Read label before use. Avoid release to the environment.

PCS 06716

 **CMPA**

**Marketing company**

Compagnie Méditerranées des Produits pour l'Agriculture (CMPA)  
160 Route de la Valentine, CS 70052  
13374 Marseille - France

COLUMBO 0.8 MG is a registered trademark of SBM Développement SAS  
Manufacturing date; batch No.: May be printed or embossed on packaging.  
Expiry date / Shelf life: 2 years from date of manufacture

 **SBM**  
DÉVELOPPEMENT

**Autorisation holder**

SBM Développement SAS  
60 Chemin des Mouilles  
69130 Ecully - France

**Net quantity: 12 kg**

# COLUMBO®

## 0.8 MG

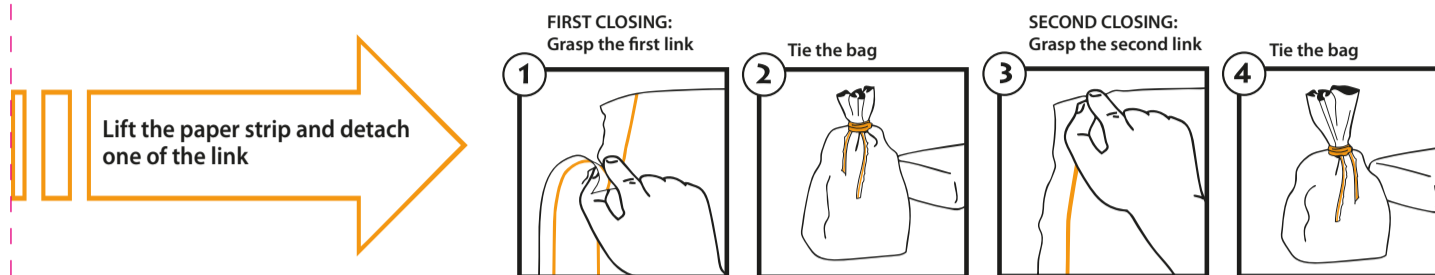

COLUMBO 0.8 MG is a ready to use microgranule formulation, applied without prior preparation or dilution. The product is applied in the furrow at sowing, planting or transplanting. With the help of seed drill or planters, granules are buried into the seed bed soil simultaneously with the seed or plant, in order to create a protective barrier around the seed or the plant.

### MODE OF ACTION

COLUMBO 0.8 MG contains cypermethrin, active substance belonging to the synthetic pyrethroids' family (IRAC 3A). Cypermethrin acts mainly by contact but also by ingestion without mobility in the soil; its persistence of activity in the soil varies depending on the more or less important quantity of light. Effective against a large number of soil pests, in particular wireworms. Persistence of COLUMBO 0.8 MG varies from 1.5 to 2 months.

The repeated use, on the same plot, of mixtures with active substances of the same chemical family or having the same mode of action can lead to make resistant organisms. To reduce this risk, it is advised to take turns or split, on the same plot, mixtures composed with active substances coming from different chemical families or with different mode of actions.

### FIRST AID MEASURES

As a general rule, if in doubt or if symptoms persist, seek medical attention. NEVER give anything by mouth to someone who is unconscious.

**In the event of exposure by inhalation:** If the product has been inhaled, lead the person concerned to the open air, keeping them warm and immobile.

If the person has difficulty breathing or is not breathing, give artificial respiration and seek medical attention.

Do not give anything by mouth to the affected person.

**In the event of splashes or contact with eyes:** Rinse thoroughly with fresh water for at least 15 minutes, keeping the eyelids wide open. Refer the person to an ophthalmologist, particularly if there is redness, pain, or vision disturbance.

**In case of splashes or skin contact:** Remove contaminated clothes, then rinse the affected area thoroughly with soap and water or with a suitable detergent.

DO NOT use solvents or thinners. If the contaminated area is widespread and / or there is skin damage, consult a physician or transfer the affected person to hospital.

**In case of ingestion of a small amount (less than a mouthful):** Rinse your mouth with water and consult a doctor.

In case of accidental ingestion, seek medical attention to assess the need for any clinical monitoring and treatment. Show the label.

In the event of emergency, call the National Poisons Information Centre, Beaumont Hospital, 01 809 1166 or 01 837 9964.

### DIRECTIONS FOR USE

#### HOW APPLY

The application method of COLUMBO 0.8 MG always follows the same process:

1. Opening of the soil and formation of the furrow; 2. Laying of the seed or the plant in the furrow; 3. Application of the granules; 4. Closing of the furrow.

The barrier is naturally created during the closing of the furrow in the case of the crops which are not deeply sowed. For crops which are more deeply sowed/planted, sowing or planting equipment should be equipped with a fishtail device DXP®, which purpose is to put granules within the sowing section in order to extend the protection to the seeding. A ridge is always formed at the end of the application when the furrow is closed and COLUMBO 0.8 MG is homogeneously spread in both sides of seeding furrow.

Carefully adjust the flow rate of each component of sowing or planting equipment before starting the treatment and check the spreading consistency. The seeding should be done at a speed of 6 km/hour or less. In order to ensure a good distribution of the microgranules in the depth of the furrow, where appropriate, the microgranulator shall be equipped with the Fishtail device DXP® provided by CMPA. The fishtail DXP® spreading system is mounted on a disc plough seeders and planter. Installation instructions and fishtail devices are available on request. Advice on installation can be found at [www.belem-sav.com](http://www.belem-sav.com). CMPA may not be rendered liable for the non-use of the DXP® diffuser or the use of another diffuser system when applying COLUMBO 0.8 MG. Likewise, the fishtail device DXP® diffuser having been specifically designed for the application of COLUMBO 0.8 MG, CMPA is not liable for its use for the application of other microgranules than COLUMBO 0.8 MG.

Do not apply by broadcast application. Product may only be applied with sowing/ planting equipment capable of placing this product in furrow simultaneously with the seed.

### WHERE TO USE

Crop	Pests Controlled	Application		
		Single dose	Method Latest time of application	Fishtail device QDC DXP®
Carrot	Wireworm	12 kg/ha	Application in furrow, by incorporation into the seed bed At sowing time	-
Sugar beet, Beetroot	Wireworm	12 kg/ha	Application in furrow, by incorporation into the seed bed At sowing time	-
Celeriac, Parsnip, Parsley root, Horseradish, Radishes, Turnips and Swedes	Wireworm	12 kg/ha	Application in furrow, by incorporation into the seed bed At sowing time	-
Broccoli, Cauliflower, Head cabbage, Brussel sprouts, Kale and Chinese cabbage	Wireworm	12 kg/ha	Application in furrow, by incorporation into the seed bed At sowing and transplanting time	- DXP® L
Potato	Wireworm	24 kg/ha	Application in furrow, by incorporation into the seed bed At planting time	DXP® L
Garlic, Onion, Shallots	Wireworm	12 kg/ha	Application in furrow, by incorporation into the seed bed At planting time	DXP® L
Oilseed Rape	Wireworms	12 kg/ha	Application in furrow, by incorporation into the seed bed At sowing time	-
Pumpkin	Wireworms	12 kg/ha	Application in furrow, by incorporation into the seed bed At sowing and planting time	- DXP® L
Tomato, Aubergine (Field)	Wireworms Cutworms	12 kg/ha	Application in furrow, by incorporation into the seed bed At sowing and transplanting time	- DXP® L
Amenity grassland	Wireworms Cutworms	12 kg/ha	Application in furrow, by incorporation into the seed bed At sowing time	-

Maximum Number of applications: 1.

### STORAGE AND DISPOSAL

Store COLUMBO 0.8 MG in its original packaging, tightly closed, protected from light, at room temperature, in a dry, ventilated and locked place. Protect from frost. Keep away from direct sunlight. When handling the product and during application, make sure to wear suitable protective clothing (gloves and work clothes). Avoid any contact with the skin and eyes.

Eliminate product and its container like toxic rubbish. Reuse of packaging is prohibited. Dispose of contents/container to a licenced hazardous waste disposal contractor or collection site except for triple rinsed empty containers which can be disposed of as non-hazardous waste. Contact your local council for details.

### IMPORTANT

In any situation where there is a high risk of wireworm attack, the following good agricultural practices must be implemented to reduce the duration of the crop's susceptibility to wireworms, by promoting rapid growth at the beginning: a starter fertilizer; choice of varieties with good initial vigour and/or limiting the depth of sowing. Insofar as external factors specific to agro-climatic conditions and/or to the specific sensitivity of the crop (seed quality: germination rate, germinative energy,...) are likely to have a determining influence, the efficacy of the product cannot be guaranteed for all conditions of use. If you are unsure about the application, please consult your distributor.

Comply with the uses, doses, conditions and the safety precautions marked on the packaging. These were determined based on the product characteristics and applications for which it is recommended. It is your responsibility to ensure that crop applications are in accordance with good agricultural practices, taking into consideration the specific conditions of your farm, such as the soil type, weather conditions... The manufacturer guarantees the quality of the product when sold in its original packaging and when used in compliance with the conditions of its authorisation.